

EPSON STYLUS™ CX5400

All in One Product

All rights reserved. No part of this publication may be reproduced, stored in a retrieval system, or transmitted in any form or by any means, electronic, mechanical, photocopying, recording, or otherwise, without the prior written permission of SEIKO EPSON CORPORATION. The information contained herein is designed only for use with this EPSON printer. EPSON is not responsible for any use of this information as applied to other printers.

Neither SEIKO EPSON CORPORATION nor its affiliates shall be liable to the purchaser of this product or third parties for damages, losses, costs, or expenses incurred by the purchaser or third parties as a result of accident, misuse, or abuse of this product or unauthorized modifications, repairs, or alterations to this product, or (excluding the U.S.) failure to strictly comply with SEIKO EPSON CORPORATION's operating and maintenance instructions.

SEIKO EPSON CORPORATION shall not be liable for any damages or problems arising from the use of any options or any consumable products other than those designated as Original EPSON Products or EPSON Approved Products by SEIKO EPSON CORPORATION.

SEIKO EPSON CORPORATION shall not be held liable for any damage resulting from electromagnetic interference that occurs from the use of any interface cables other than those designated as EPSON Approved Products by SEIKO EPSON CORPORATION.

EPSON is a registered trademark and EPSON Stylus is a trademark of SEIKO EPSON CORPORATION.

General Notice: Other product names used herein are for identification purposes only and may be trademarks of their respective owners. EPSON disclaims any and all rights in those marks.

Copyright © 2003 by SEIKO EPSON CORPORATION, Nagano, Japan.

Stylus CX Parts

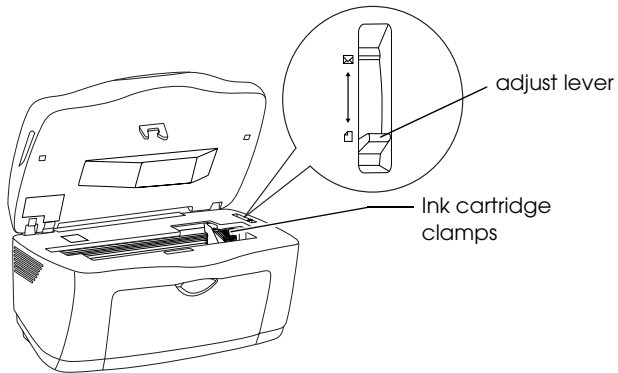
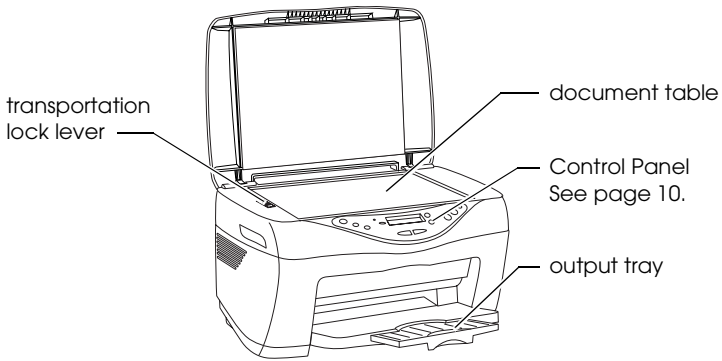
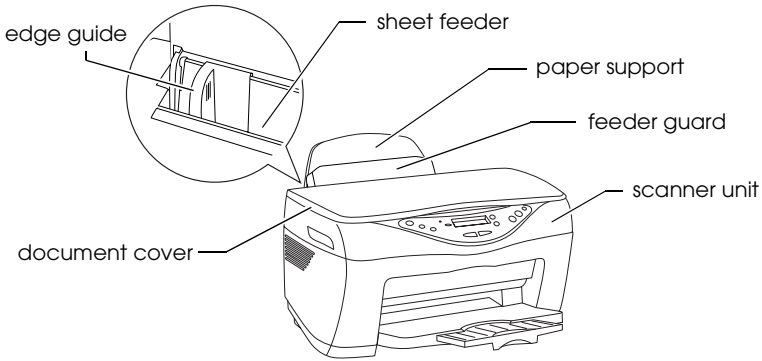

Safety Information

Warnings, Cautions, and Notes	5
Safety Instructions	5

Control Panel Functions

LCD Panel	10
Lights	10
Buttons	11

Copying

Overview of the Basic Procedure	12
Loading Paper	14
Placing a Document	16
Canceling copying	17

Replacing Ink Cartridges

About Ink Cartridges	18
Checking the Ink Supply	18
Precautions on Ink Cartridge Replacement	19
Replacing an Ink Cartridge	20

Menu Items

Safety Information

Warnings, Cautions, and Notes



Warnings

must be followed carefully to avoid bodily injury.



Cautions

must be observed to avoid damage to your equipment.

Notes

contain important information and useful tips on the operation of this product.

Safety Instructions

Read all of the instructions in this section when setting up and using this product.

When choosing a place for this product

- Avoid places subject to rapid changes in temperature and humidity. Also, keep this product away from direct sunlight, strong light, and heat sources.
- Avoid places subject to dust, shocks, and vibrations.
- Leave enough room around this product to allow for sufficient ventilation.
- Place this product near a wall outlet where the plug can be easily unplugged.

- ❑ Place this product on a flat, stable surface that extends beyond this product base in all directions. If you place this product by the wall, leave more than 10 cm between the back of this product and the wall. This product will not operate properly if it is tilted at an angle.
- ❑ When storing or transporting this product, do not tilt it, stand it on its side, or turn it upside down; otherwise, ink may leak from the cartridge.

When choosing a power source

- ❑ Use only the power cord that comes with this product. Use of another cord may result in fire or electric shock.
- ❑ This product's power cord is for use with this product only. Use with other equipment may result in fire or electric shock.
- ❑ Use only the type of power source indicated on the label on the back of this product.
- ❑ Be sure your AC power cord meets the relevant local safety standards.
- ❑ Do not use a damaged or frayed power cord.
- ❑ If you use an extension cord with this product, make sure that the total ampere rating of the devices plugged into the extension cord does not exceed the cord's ampere rating. Also, make sure that the total ampere rating of all devices plugged into the wall outlet does not exceed the wall outlet's ampere rating.
- ❑ If you plan to use this product in Germany, the building installation must be protected by a 10 or 16 amp circuit breaker to provide adequate short-circuit protection and over-current protection for this product.

When handling ink cartridges

- ❑ Do not open the ink cartridge packages until just before you install them.
- ❑ Before installing the new ink cartridge, shake it four or five times before opening its package.
- ❑ Do not shake the ink cartridge after removing from the package; this can cause leakage.
- ❑ Be careful not to break the hooks on the side of the ink cartridge when you remove it from the package.
- ❑ Keep ink cartridges out of the reach of children. Do not allow children to drink from or otherwise handle the cartridges.
- ❑ Store each ink cartridge with its label facing upward. Do not store cartridge upside down.
- ❑ Do not remove or tear the blue label on the cartridge; this can cause leakage.
- ❑ Be careful when you handle used ink cartridges, as there may be some ink remaining around the ink supply port. If ink gets on your skin, wash the area thoroughly with soap and water. If ink gets into your eyes, flush them immediately with water. If discomfort or vision problems remain after a thorough flushing, see a doctor immediately.

- ❑ Do not touch the green IC chip on the side of the cartridge. This can damage the ink cartridge.

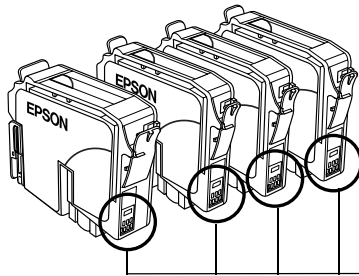

Do not touch this part

When using this product

- ❑ Do not put your hand inside this product or touch the ink cartridges during printing.
- ❑ Do not block or cover the openings on this product.
- ❑ Do not attempt to service this product yourself.
- ❑ Unplug this product and refer servicing to qualified service personnel under the following conditions:
The power cord or plug is damaged; liquid has entered this product; this product has been dropped or the cover damaged; this product does not operate normally or exhibits a distinct change in performance.
- ❑ Do not insert objects into the slots on this product.
- ❑ Take care not to spill liquid on this product.
- ❑ Leave the ink cartridges installed. Removing the cartridges can dehydrate the print head and may prevent this product from printing.

When using the LCD panel

- ❑ Only use a dry, soft cloth to clean the display. Do not use liquid or chemical cleansers.
- ❑ If the display on this product is damaged, contact your dealer.
- ❑ If the liquid crystal solution contained in the LCD panel leaks out and gets on your hands, wash them thoroughly with soap and water, if the liquid crystal solution gets into your eyes, flush them immediately with water, if discomfort or vision problems remain after a thorough flushing, see a doctor immediately.

Control Panel Functions

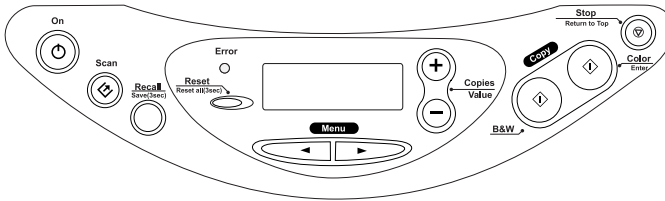

LCD Panel

When you turn on this product, the LCD panel shows the current copy settings, number of copies, and the  ink drop icon. This state of the LCD panel is called the "normal display".

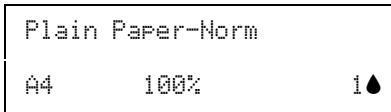

You can also check the error messages on the LCD panel. For details of the error messages, see the online *Copy Guide*.

Lights

Light	Pattern	Status
On	On	This product is on.
	Flashing	While Initializing, data processing, copying, printing, scanning, charging ink and cleaning, and replacing an ink cartridge.
Error	On	An error occurs.

Buttons

Buttons	Function
⏻ On	Turns this product on and off.
◊ Scan	Starts EPSON Smart Panel by default. Before using this feature, make sure you have installed EPSON Scan and EPSON Smart Panel from the software CD and connect this product to your computer.
Recall	Recalls the copy settings stored in the memory. When you press and hold the Recall button for 3 seconds, all of the settings are stored in the memory.
Reset	Resets the number of copies to one when the LCD panel is in normal display. Resets the values to their defaults when a menu item appears on the LCD panel. When you press and hold the Reset button for 3 seconds, all of the settings except language return to their defaults.
Menu	Display the menu items on the LCD panel.
Copies/Value	Increase or decrease the number of copies when the LCD panel is in normal display. Select an item or increase or decrease the setting's value when a menu item appears on the LCD panel.
◊ B&W Copy	Copies in grayscale.
◊ Color Copy	Copies in color. Performs the function indicated in "Press the Color copy button to xxx (indicating a function)".
⏹ Stop	Stops copying. The sheet being copied is ejected. Returns to the normal display when a menu item appears on the LCD panel.

Copying

Overview of the Basic Procedure

This section outlines the basic copying procedure to make copies in the Standard Copy mode, as follows:

1. Turn on this product.
2. Load paper in the sheet feeder and then place a document on the document table. For instructions, see the appropriate sections described below.

“Loading Paper” on page 14

“Placing a Document” on page 16

3. Press one of the Menu buttons until Copy mode appears on the LCD panel, and then select Standard.

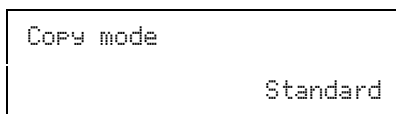

Note:

Be sure to select the copy mode first, because other copy settings return to their default values when the copy mode changes.

If you want to copy in another copy mode, see the online *Copy Guide*.

4. Change any necessary copy settings. For instructions, see the appropriate sections described below.

Menu items	Setting items/values	
Number of Copies	1* to 99	
Quality&Paper	Plain Paper-Econ Plain Paper-Norm* Plain Paper-Fine PQIJ Paper-Fine PQIJ Paper-Photo	Matte Paper HW Photo Paper PSGP Paper DB Photo Paper
Paper size	A4* A5	10 × 15
Lighter/Darker	Five steps	
Reduce/Enlarge	Actual: 100%* Auto Fit Page A4 -> A5 A5 -> A4	10 × 15 -> A4 A4 -> 10 × 15 4 × 6 -> A4
Zoom In/Out	25 to 400% in 1% increments	

* indicates the default setting.

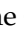
5. Press the  Stop button to return to the normal display, and then confirm the selected settings.

Plain Paper-Norm		
A4	100%	1 

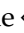
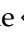
6. Press the  Color Copy button to copy in color, or the  B&W Copy button to copy in grayscale.

This product starts copying.



Caution:

Do not open the scanner unit during scanning or copying; otherwise, you may damage this product.

Note:

- ❑ *The copied image may not have exactly the same size as the original image.*
- ❑ *When you select Photo Paper, PSGP Paper, or DB Photo Paper as Quality & Paper and then press the \diamond B&W Copy button, a warning message appears and copying stops. If this happens, press the \odot Stop button, and then change the Quality & Paper settings.*
- ❑ *While copying is in progress, if a message appears on the LCD panel indicating ink is low, you can continue making copies until ink runs out, or stop making copies and then change the appropriate ink cartridge immediately.*

Loading Paper

This section provides instructions on how to load paper in the sheet feeder.

Note:

Leave enough space in front of this product for paper to be fully ejected.

1. Lower the output tray, and then slide out the extension.

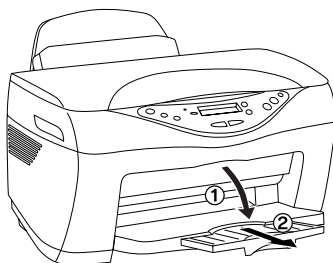

2. Move the feeder guard towards you.

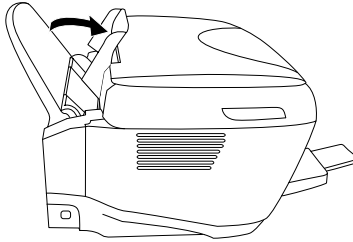

3. Fan a stack of paper, and then tap it on a flat surface to even the edges.
4. Slide out the left edge guide. Load the stack of paper with the printable side up so it is resting against the right side of the feeder, and then slide the edge guide against the paper.

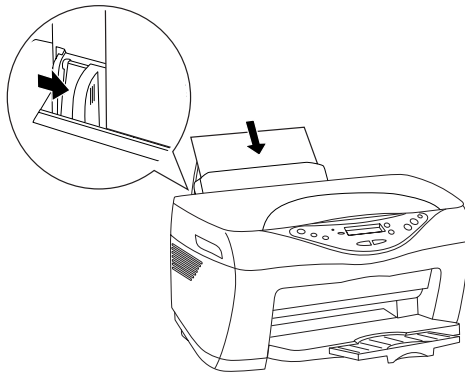

Note:

- ❑ Always load paper into the sheet feeder's short edge first.
- ❑ Use the line on the feeder guard as an indicator when loading paper. The right edge of paper is aligned with the line on the feeder guard.
- ❑ Make sure that the paper stack fits under the arrow mark inside the edge guide.

5. Set the feeder guard back.

Note:

If the paper is curled, flatten it or curl it slightly toward the opposite side before loading. Printing on curled paper may cause ink to smear on your printout.

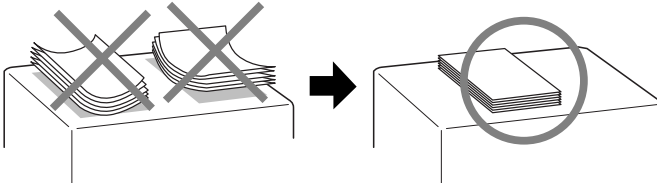

Placing a Document

This section provides instructions on how to place a document on the document table.

Note:

Always keep the document table clean.

1. Open the document cover and place an original document on the document table, with the side to be copied facing down. Make sure that the document is properly aligned.

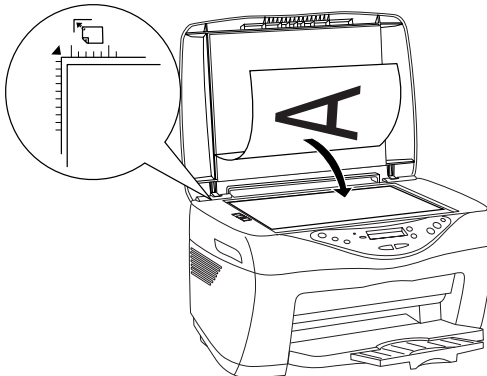

Note:

- ❑ *Make sure the document is flat against the glass surface; otherwise the image becomes out of focus. Be sure to close the document cover to prevent interference from any external light.*
- ❑ *An area of up to 2.5 mm from the edge of the document table glass cannot be scanned.*

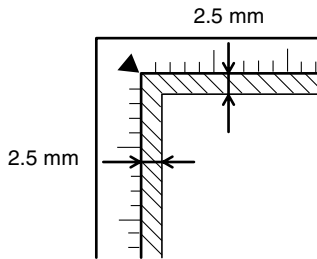

2. Close the document cover gently so that the document does not move.

Note:

- ❑ *Do not leave photographs on the document table for an extended period of time as they may stick to the glass.*
- ❑ *Do not place heavy objects on top of this product.*

Canceling copying

Press the ⏹ Stop button.

Replacing Ink Cartridges

About Ink Cartridges

You can use the following cartridges with this product.

Black ink cartridge	T0321
Color ink cartridge	
Cyan	T0422
Magenta	T0423
Yellow	T0424



Caution:

EPSON recommends the use of genuine EPSON ink cartridges. Other products not manufactured by EPSON may cause damage to this product, which is not covered by EPSON's warranties.

Checking the Ink Supply

To check your ink supply on the LCD panel, use one of the following methods. If you want to check your ink supply on your computer monitor, see the online *Reference Guide*.

LCD panel

Press one of the Menu buttons repeatedly until Ink Levels appears on the LCD panel. The amount of ink left appears.

Ink Levels
C: 80% M: 80%

Ink drop icon

You can also check the  ink drop icon on the LCD panel to see an approximate indication of the ink level.

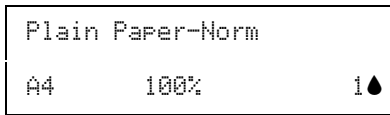

Caution:

Leave the old cartridge installed in this product until you are ready to replace it; otherwise, ink remaining in the print head nozzles may dry out.

Precautions on Ink Cartridge Replacement

Read all of the instructions in this section when replacing the ink cartridges.

- ❑ If you need to remove an ink cartridge temporarily from this product, be sure to protect the ink supply area of the ink cartridge from dirt and dust. Store the ink cartridge in the same environment as this product. When storing the cartridge, be sure that ink cartridge with its label that identifies the color of the ink cartridge facing upward. Do not store ink cartridge upside down.
- ❑ The valve in the ink supply port is designed to contain any excess ink that may be released. However, careful handling is recommended. Do not touch the supply port of the ink cartridge or its surrounding area.

- ❑ This product uses ink cartridges equipped with an IC chip. The IC chip accurately monitors the amount of ink used by each cartridge, so even if a cartridge is removed and then later inserted again, all of its ink can be used. However, some ink is consumed each time the cartridge is inserted because this product automatically checks its reliability.
- ❑ When an ink cartridge becomes empty, you cannot continue copying even if the other cartridge still contains ink. Before copying, replace the empty cartridge.
- ❑ In addition to being used in document copying, ink is also consumed in the following operations: print head cleaning, self-cleaning cycle performed when this product is turned on, and ink charging when an ink cartridge is installed in this product.
- ❑ Do not refill the ink cartridges. This product calculates the amount of ink remaining using an IC chip built into an ink cartridge. Even if the cartridge is refilled, the amount of ink remaining is not recalculated by the IC chip and therefore the amount of ink available for use does not change.
- ❑ After an ink cartridge is replaced, if the ink is low it may become empty. When a message appears to indicate the ink is low, prepare a new ink cartridge.

Replacing an Ink Cartridge

Follow the steps below to replace an ink cartridge.

Note:

Before replacing, read the instructions “Safety Instructions” on page 5 and “Precautions on Ink Cartridge Replacement” on page 19.

1. Make sure this product is on and the On light is not flashing.

2. **When the ink is empty:**

Refer to the panel message to determine which ink is empty, and then press the \diamond Color Copy button.

When the ink is low:

Press one of the Menu buttons until Change Cartridge appears on the LCD panel, and then press the \diamond Color Copy button.

The ink cartridges move to the replacement position.

3. Make sure that the document cover is closed and then raise the scanner unit.

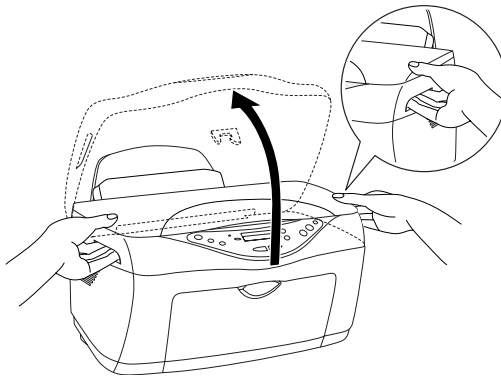

Caution:

- Do not raise the scanner unit with the document cover opened.
- Do not move the print head by hand. Doing so may damage this product.
- Do not start replacing the ink cartridge before the print head stops.

4. For best results, shake a new ink cartridge four or five times, then remove it from its the package.

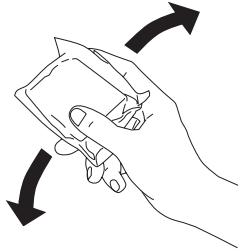

5. Pinch the sides of the ink cartridge that you want to replace. Lift the cartridge out of this product and dispose of it properly. Do not take the used cartridge apart or try to refill it.

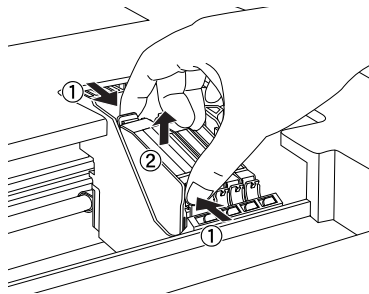

Warning:

Be careful when you are handling used ink cartridges, as there may be some ink around the ink supply port. If ink gets on your skin, wash the area thoroughly with soap and water. If ink gets into your eyes, flush them immediately with water. If discomfort or vision problems remain after thorough flushing, see a doctor immediately.



Caution:

Be sure to always install an ink cartridge into this product immediately following the removal of an old ink cartridge. If the ink cartridge is not installed promptly, the print head may dry out rendering it unable to print.

- Place the ink cartridge vertically into the cartridge holder. Push the ink cartridge down until it clicks into place.

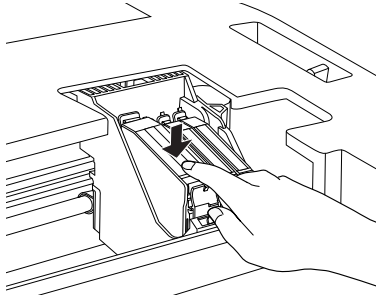

If you need to replace other ink cartridges, repeat steps 4 through 6 before continuing with step 7.

- Lower the scanner unit.

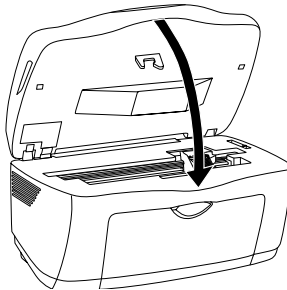

The print head moves and ink charging begins. The On light flashes while ink charging is in progress. When the On light stops flashing, ink charging is completed.



Caution:

Never turn off this product while the On light is flashing. Doing so can result in incomplete charging of ink.

Note:

After the ink cartridge is replaced, if the ink was low it may become empty. In this case, replace the ink cartridge again.

Appendix A

Menu Items

Setting menu (Using Menu Buttons)	Setting items (Using Copies/Value button)
Normal display	Number of copies: 1 to 99
↑↓	
Copy Mode	Standard/Reduced Margin/Repeat/2-up
↑↓	
Quality&Paper	Plain Paper-Econ/Plain Paper-Norm/Plain Paper-Fine/PQIJ Paper-Fine/PQIJ Paper-Photo/Matte Paper HW/Photo Paper/PSGP Paper/DB Photo Paper
↑↓	
Paper size	A4/A5/B5/Letter/Legal/Executive/Half-Letter/Photo Paper
↑↓	
Lighter/Darker	- <input type="checkbox"/> <input type="checkbox"/> <input type="checkbox"/> <input checked="" type="checkbox"/> <input type="checkbox"/> <input type="checkbox"/> <input type="checkbox"/> <input type="checkbox"/> <input checked="" type="checkbox"/> +
↑↓	
Reduce/Enlarge	The availability of Reduce/Enlarge setting depends on the copy mode and paper size.
↑↓	
Zoom In/Out	25 to 400 % in 1 % increments
↑↓	
Language	English/Spanish/Portuguese/French, German/Italian/Dutch
↑↓	
Head Alignment	Press the Color copy button to print head alignment.
↑↓	
Nozzle Check	Press the Color copy button to print nozzle check pattern.
↑↓	
Head Cleaning	Press the Color copy button to start head cleaning.
↑↓	
Change Cartridge	Press the Color copy button to replace the ink cartridge.
↑↓	
Ink Levels	Display the amount of the ink level.
↑↓	
Load/Eject	Press the Color copy button to load or eject the paper.

Note:

Depending on Copy mode, some setting is not available.