

# Guida per inceppamenti



**Attenzione** Le informazioni contenute nei messaggi precedenti dall'icona Attenzione devono essere osservate per evitare danni alle attrezzature.

Quando sul pannello LCD viene visualizzato il messaggio di errore Inceppamento XXX, scegliere la descrizione appropriata per rimuovere la carta inceppata. Per ulteriori informazioni, vedere la Guida di riferimento in linea.

## Inceppamento B (coperchio B)

1

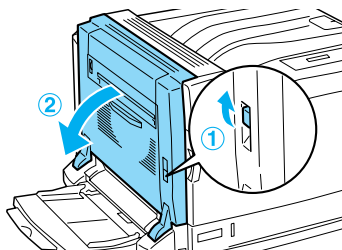

2

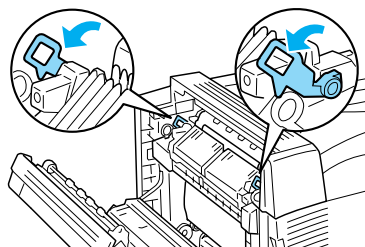

### Attenzione

Non toccare il rullo di trasmissione (rullo in gomma nero) dell'unità di trasmissione o il rullo di trasmissione dell'unità di trasmissione intermedia. Altrimenti, la qualità di stampa può venire compromessa o il rullo di trasmissione può venire danneggiato e dovrà essere sostituito.

Rullo di trasmissione (rullo di gomma nero) dell'unità di trasmissione

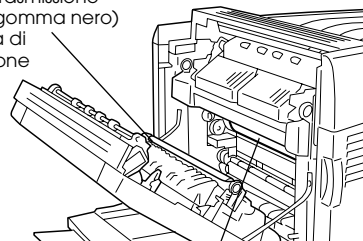

Rullo di trasmissione dell'unità di trasmissione intermedia

3

Fessura di uscita carta

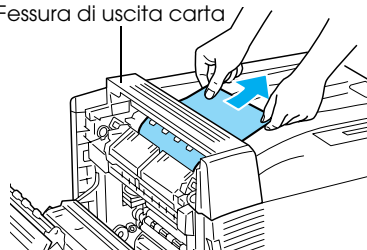

Se l'estremità della carta inceppata fuoriesce dalla fessura di uscita carta, rimuovere delicatamente la carta dalla fessura e procedere al passaggio 5.

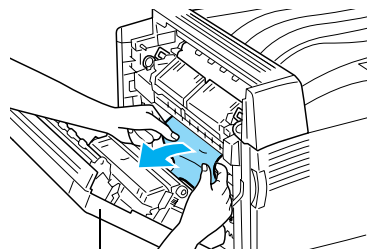

coperchio B

Se la carta inceppata non fuoriesce dalla fessura di uscita carta, rimuovere la carta inceppata all'interno del coperchio B.

4

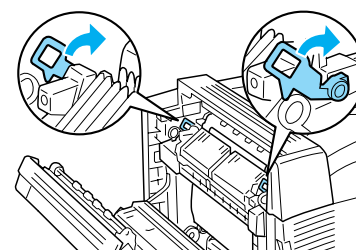

5

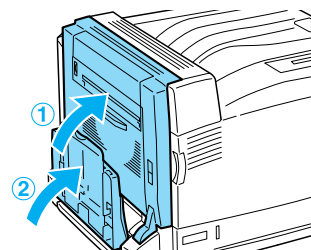

## Per carta formato lungo

1

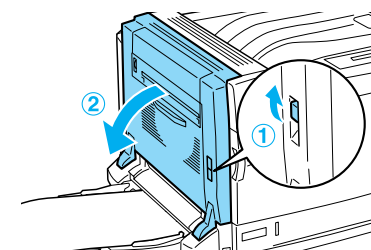

2

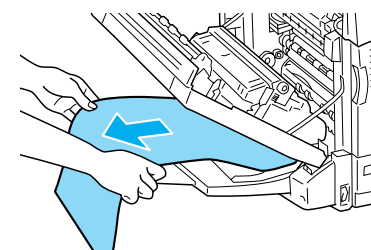

3

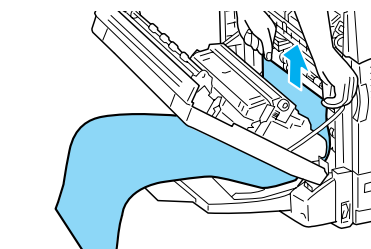

Continua alla pagina seguente ... ➡

## Inceppamento B (coperchio B)

Per carta formato lungo  
(continua)

4

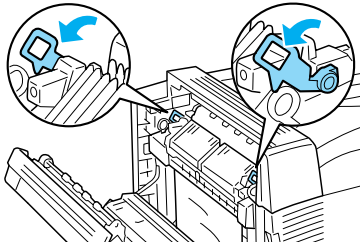

5

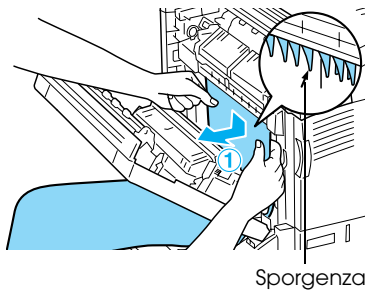

6

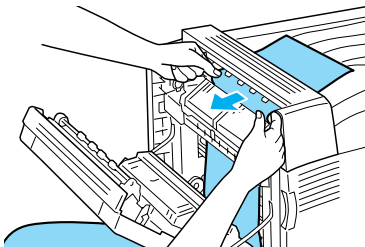

7

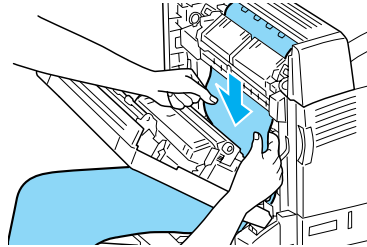

8

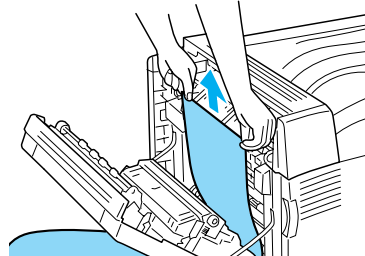

9

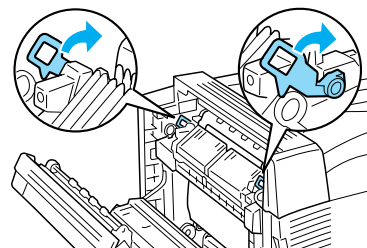

10

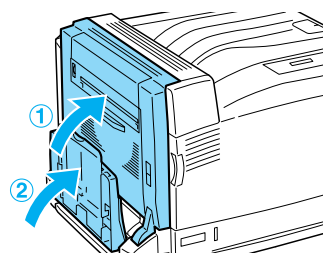

## Inceppamento E (coperchio E)

Per l'unità opzionale cassetto  
carta da 500 fogli A3

1

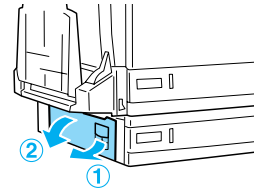

2

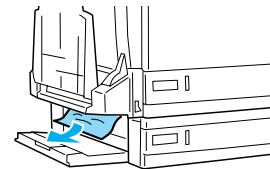

3

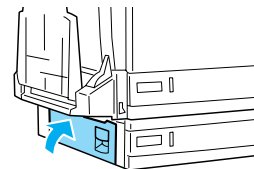

Per l'unità opzionale cassetto  
carta da 1500 fogli A3

1

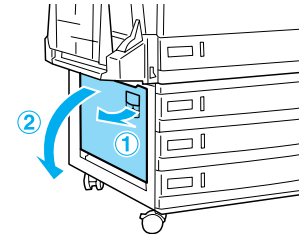

2

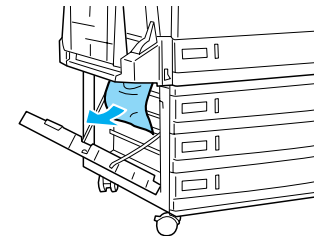

3

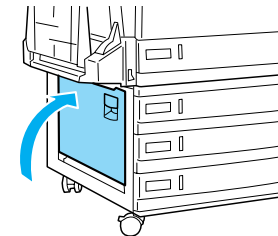

**Inceppamento B, C1**  
**(coperchio B e cassetto carta inferiore standard)**

1

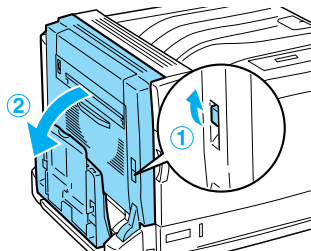

2

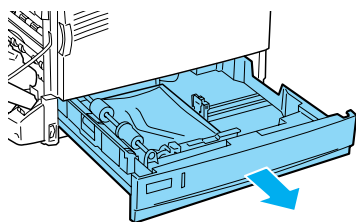

3

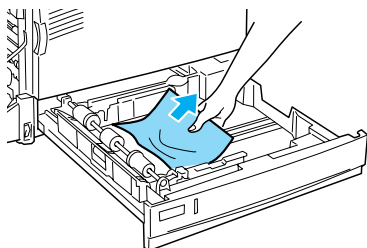

4

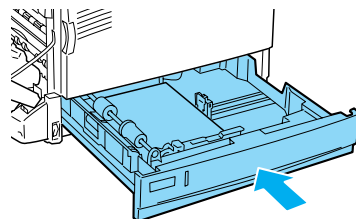

5

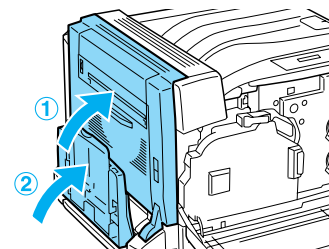

**Inceppamento E, C2/E, C3/E, C4**  
**(coperchio E e cassette carta opzionali)**

**Per l'unità opzionale cassetto  
carta da 500 fogli A3**

1

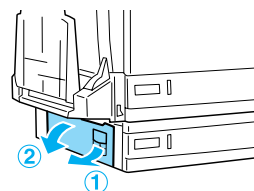

3

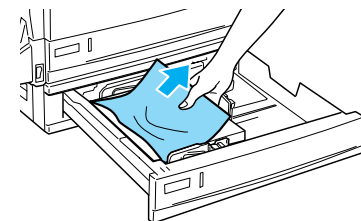

Se si individua la carta inceppata,  
attenersi al passaggio 2 di  
Inceppamento E per rimuoverla  
tenendone l'estremità. Quando la  
carta inceppata è stata rimossa,  
procedere al passaggio 5.

4

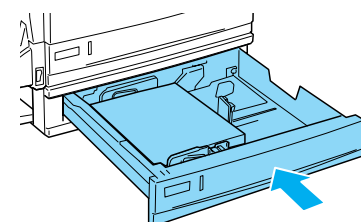

2

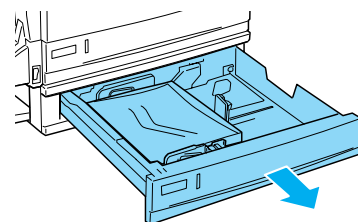

5

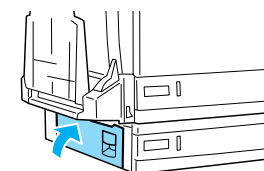

## Inceppamento E, C2/E, C3/E, C4 (coperchio E e cassette carta opzionali)

Per l'unità opzionale cassetto  
carta da 1500 fogli A3

1

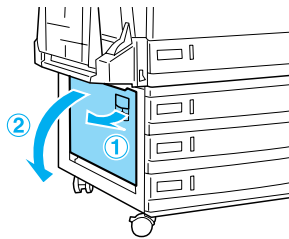

Se si individua la carta inceppata,  
attenersi al passaggio 2 di  
Inceppamento E per rimuoverla  
delicatamente tenendone  
l'estremità. Quando la carta  
inceppata è stata rimossa,  
procedere al passaggio 5.

2

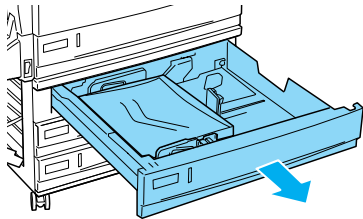

3

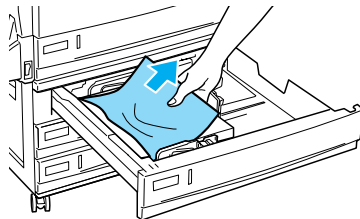

4

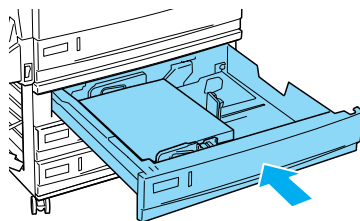

5

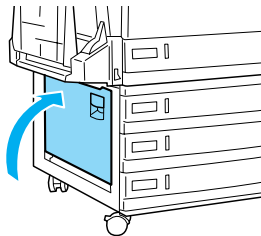

## Inceppamento B, D (coperchio B e unità fronte/retro opzionale)

1

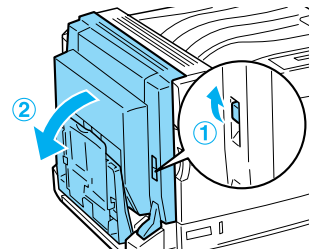

4

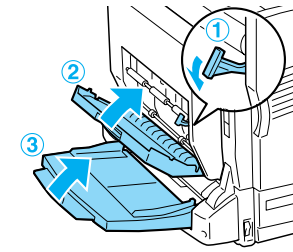

Se l'estremità della carta è visibile,  
attenersi al passaggio 2 di  
Inceppamento B per rimuovere la  
carta tenendone l'estremità.

2

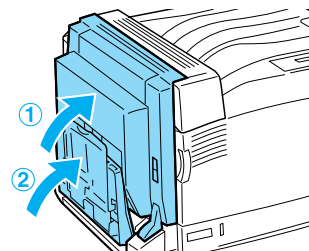

3

