

Guia Encravamento Papel



Importante: Mensagens que contêm instruções que devem ser seguidas para não provocar danos no equipamento.

Quando aparecer a mensagem de erro Jam XXX (Encrav XXX) no visor LCD, selecione a descrição apropriada para retirar o papel encravado.

Para mais informações, consulte o guia de consulta interativo.

Encravamento B (tampa B)

1

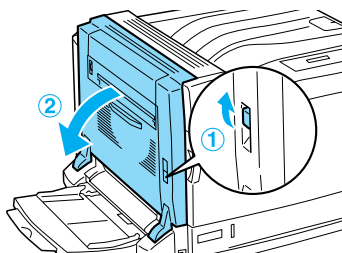

2

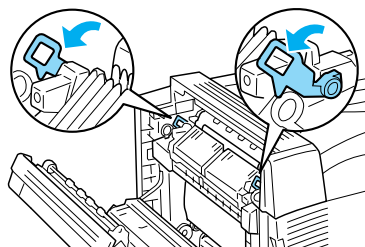

3

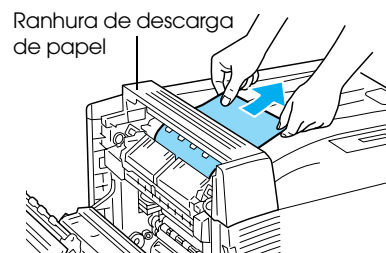

Se a extremidade do papel encravado for visível na ranhura de descarga de papel, retire o papel da ranhura com cuidado e avance para o ponto 5.

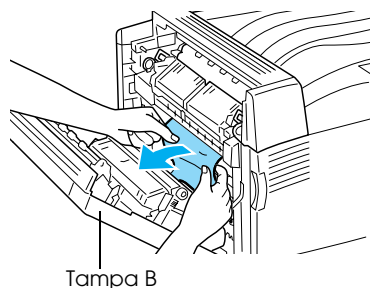

4

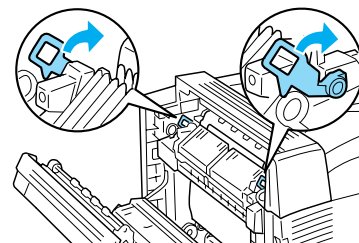

5

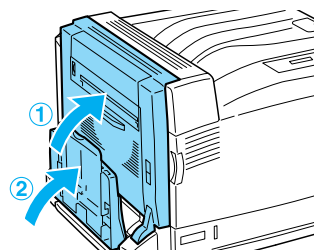

Para papel comprido

1

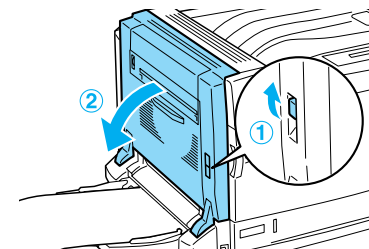

2

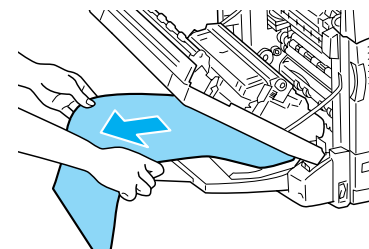

3

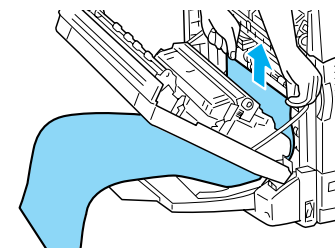

Importante:

Não toque no rolete de transferência (rolete de borracha preta) da unidade de transferência ou no rolete de transferência da unidade de transferência intermédia. Caso contrário, a qualidade de impressão poderá diminuir ou poderá danificar e ter de substituir o rolete de transferência.

Roleta de transferência (rolete de borracha preta) da unidade de transferência

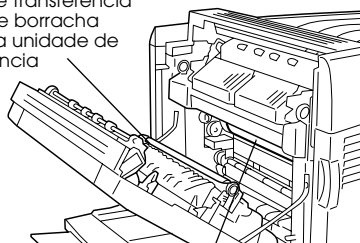

Roleta de transferência da unidade de transferência intermédia

Se o papel encravado não for visível na ranhura de descarga de papel, retire o papel encravado a partir do interior da tampa B.

Continuação na página seguinte ... ➡

Encravamento B (tampa B)

Para papel comprido
(continuação)

4

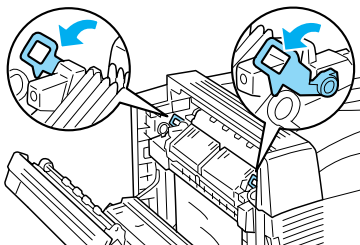

7

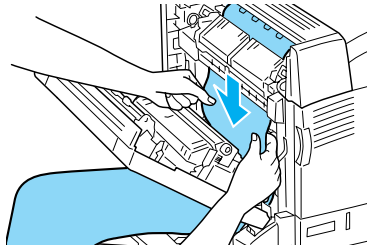

5

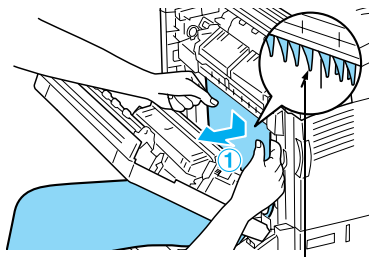

Protuberância

8

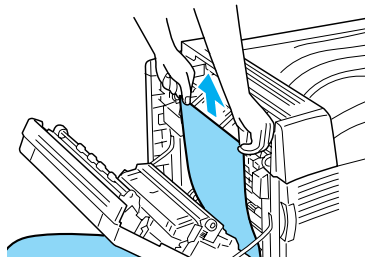

9

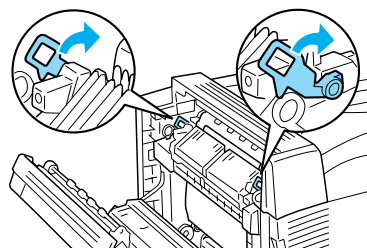

6

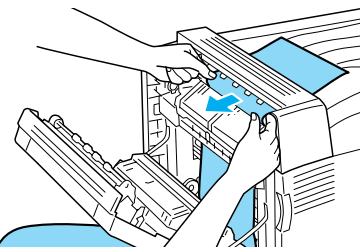

10

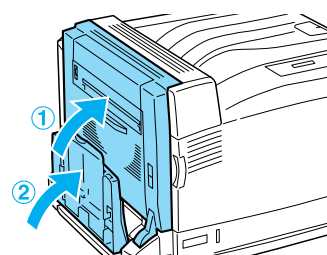

Encravamento E (tampa E)

Para o alimentador para 500
folhas A3 opcional

1

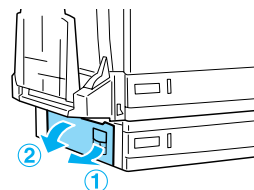

2

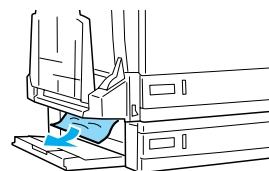

3

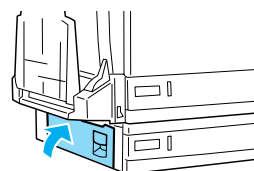

Para o alimentador para 1500
folhas A3 opcional

1

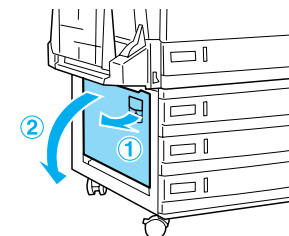

2

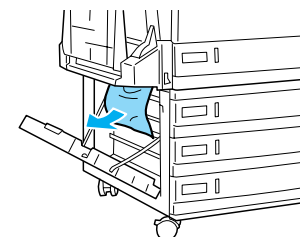

3

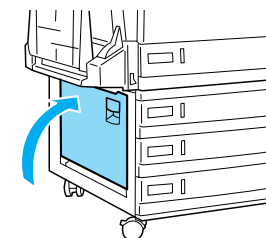

Encravamento B, C1
(tampa B e alimentador inferior padrão)

1

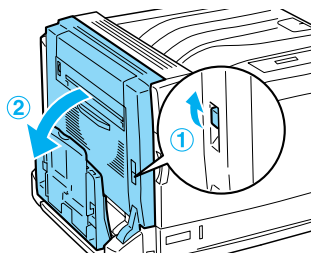

2

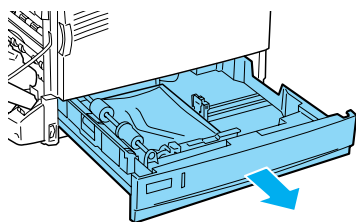

3

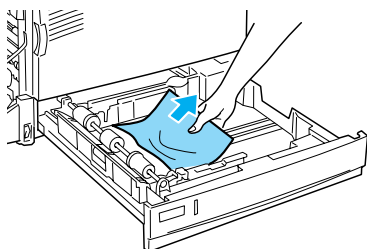

4

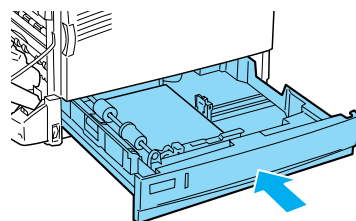

5

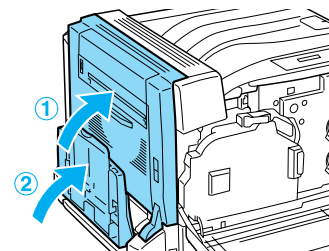

Encravamento E, C2/E, C3/E, C4
(tampa E e alimentadores opcionais)

**Para o alimentador para 500
folhas A3 opcional**

1

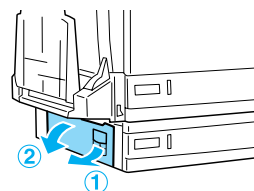

Se encontrar o papel encravado,
execute as operações descritas no
ponto 2 de Encravamento E para
retirar o papel, segurando-o pela
extremidade. Quando tiver
retirado o papel encravado,
avance para o ponto 5.

2

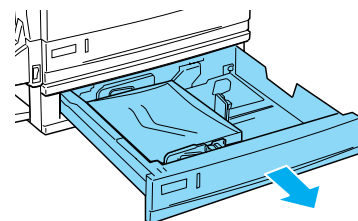

3

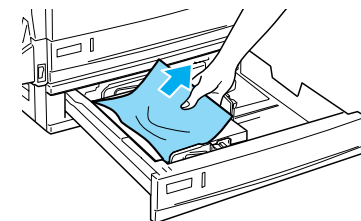

4

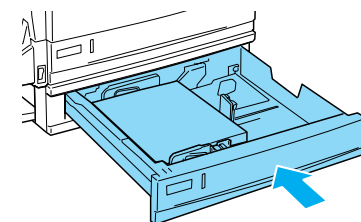

5

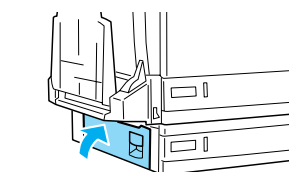

Encravamento E, C2/E, C3/E, C4 (tampa E e alimentadores opcionais)

Para o alimentador para 1500
folhas A3 opcional

1

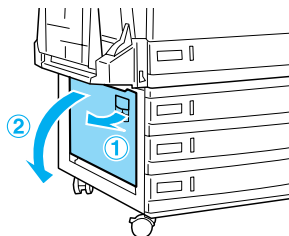

Se encontrar o papel encravado,
execute as operações descritas no
ponto 2 de Encravamento E para
retirar o papel, segurando-o pela
extremidade. Quando tiver
retirado o papel encravado,
avance para o ponto 5.

2

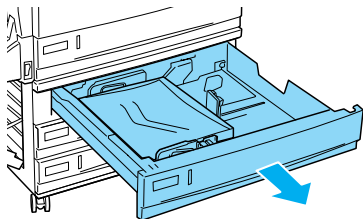

3

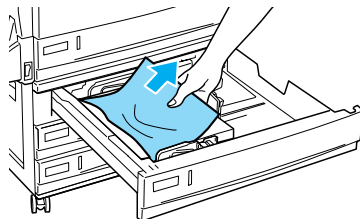

4

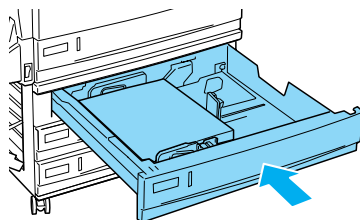

5

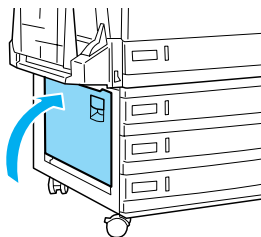

Encravamento B, D (tampa B e unidade dúplex opcional)

1

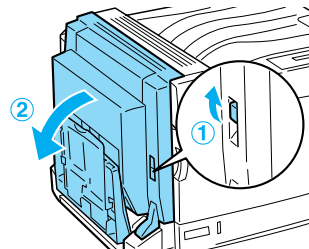

Se a extremidade do papel for
visível, execute as operações
descritas no ponto 2 de
Encravamento B para retirar o
papel, segurando-o pela
extremidade.

2

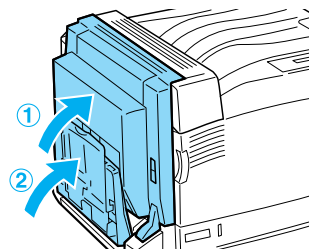

3

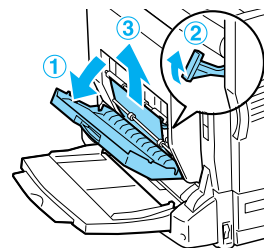

4

