

Sleeve platen (C12C891191)

Notes on how to handle this product safely are also included in the main printer manual. Make sure you read those notes together with this guide.

List of accessories

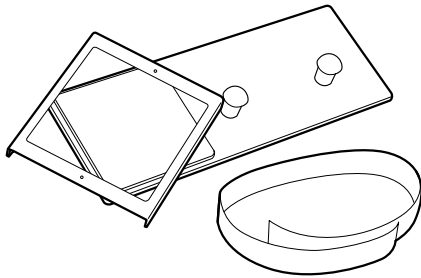

Product Specifications	
Dimensions	(W) 147 x (D) 379 x (H) 46 mm
Weight	0.9 kg

Areas that Cannot be Printed

The section that is lifted up one level inside the platen frame is the print surface. As shown in the gray areas in the following image, 12 mm from the edges of the lifted section cannot be printed. The area (4 x 4 inches) inside the gray area is the printable region.

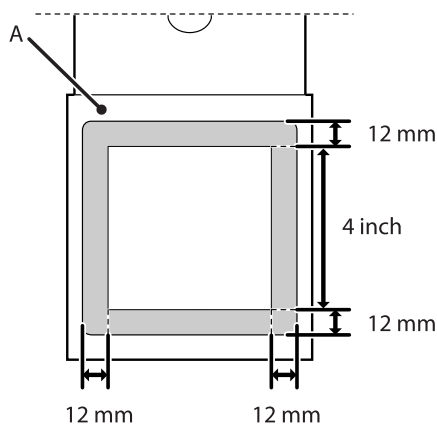

A: Platen frame

Replacing the Platen

Before attaching the sleeve platen, remove the labeled round part under the parallel adjustment plate. You need a cross-head screwdriver to remove this part.

- 1 See the "User's Guide" to remove the labeled round part.

"User's Guide" - "Removing the Labeled Round Part"

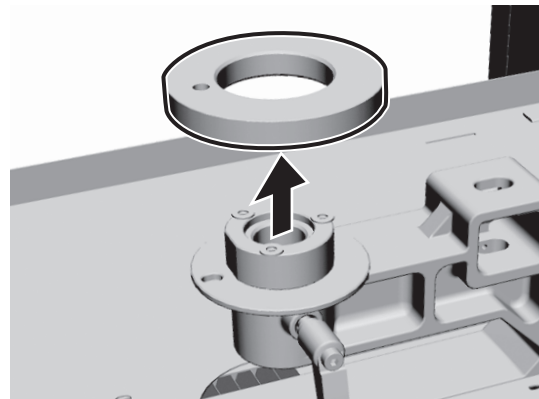

! Important:
If the sleeve platen is used without removing the labeled round part, it may strike the exterior of the printer when the movable base operates.

- 2 Attach the sleeve platen.

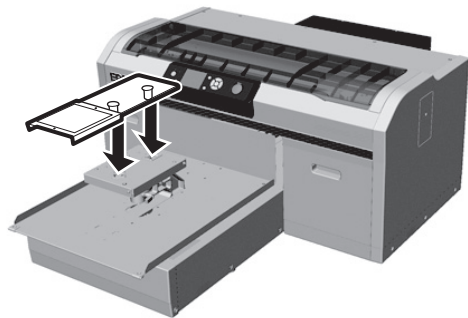

Sleeve platen (C12C891191)

- 3** Place a securing band in the groove on the platen's top surface.

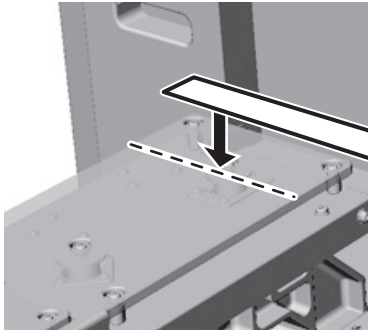

- 4** Wrap the securing band firmly around the base of the parallel adjustment plate.

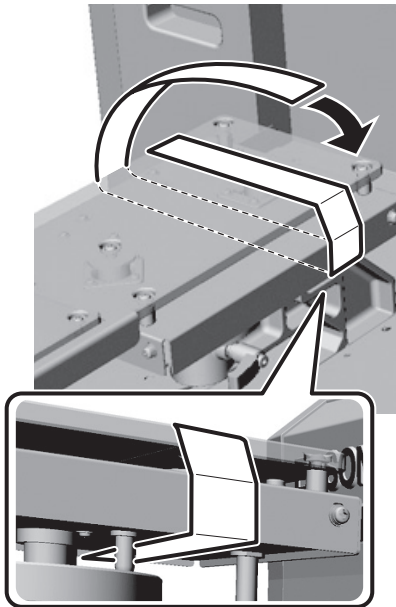

- 5** Make sure the end of the securing band is at the side.

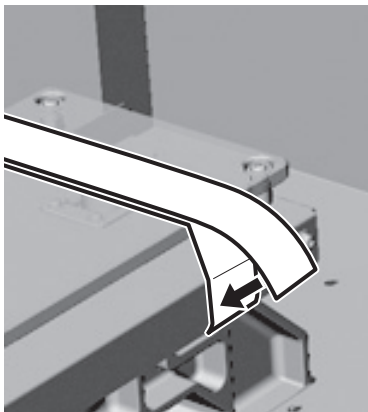

Loading on the Platen

- 1** Check that the sleeve platen is ejected forward.
If it is not ejected, press the  button to move the platen forward.

- 2** Remove the platen's frame.

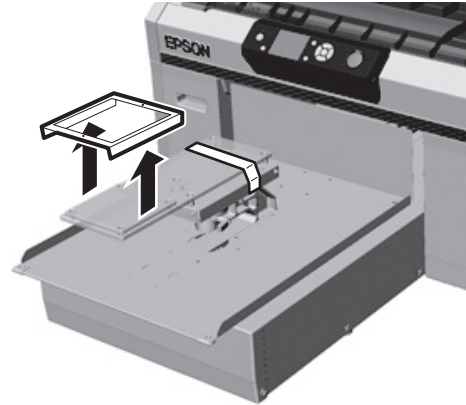

- 3** Pass the sleeve of the T-shirt over the platen.

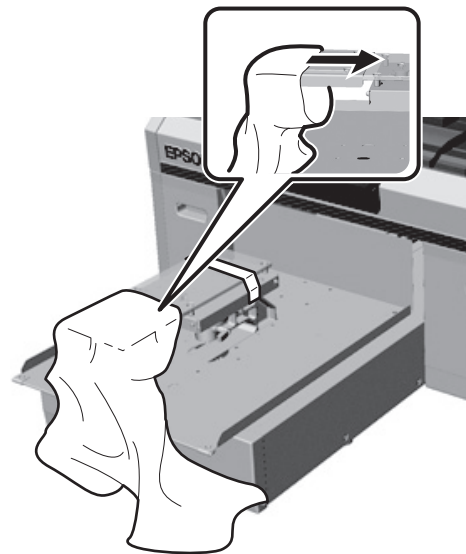

Sleeve platen (C12C891191)

- 4 Smooth out the printing surface so that it is flat.



! Important:
Position the T-shirt so that the seams on the cuff and the sleeve are not on the top surface. If the print surface is uneven, a **Platen Height Error** occurs, and print quality declines.

- 5 Attach the platen frame again.

Attach so that the small holes on the frame are facing towards the front and back as shown in the following illustration.

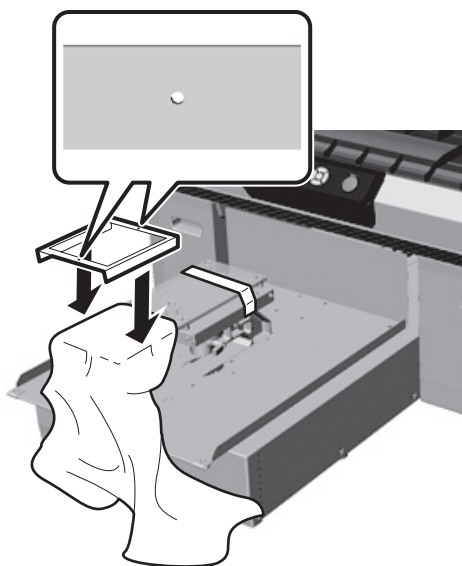

- 6 Smooth out any creases and slack to make the printing surface flat.

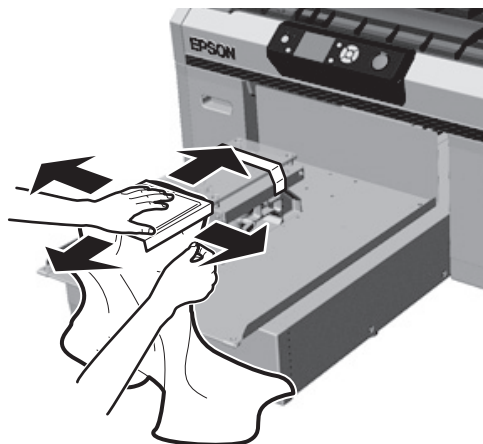

- 7 Pull the part of the T-shirt that is outside of the frame to remove any creases and slack.

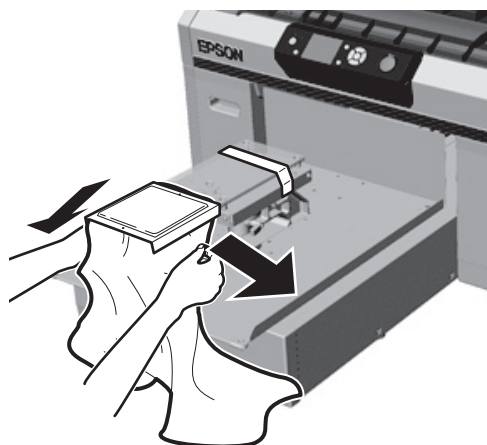

- 8 Press down the frame of the platen so that it does not become loose.

- 9 Tuck in the T-shirt around the frame so that it does not drape over the movable base.

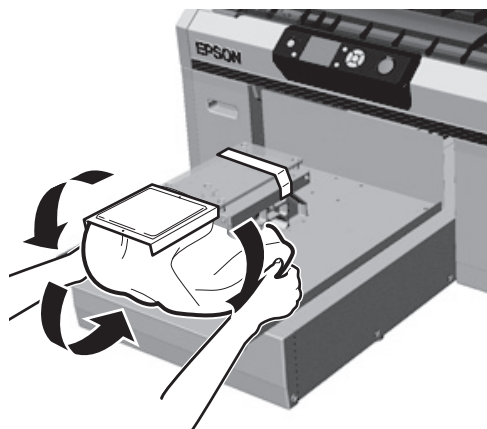

Adjusting the Height

For sleeve platen height adjustment, you cannot check the label position because the labeled section was removed. Therefore, move the height adjustment lever all the way to the left, and then move it three steps to the right. This is the recommended position to start height adjustment. See the User's Guide for details on subsequent adjustments.

 "User's Guide" - "Adjusting the Height"

Notes when Using the Heat Press

When using a heat press to fixate the pre-treatment liquid or ink, to avoid unevenness from the seams on the cuff and the sleeve, we recommend placing a heat-resistant sheet between the fabric before starting.